

REVISIONS			
REV.	DESCRIPTION	DATE	APPROVED
0	RELEASED FOR PRODUCTION	10/23/06	ON FILE
B	UPDATED FOR REVISED XP2I PER ECO 09-036	6/5/2009	ON FILE

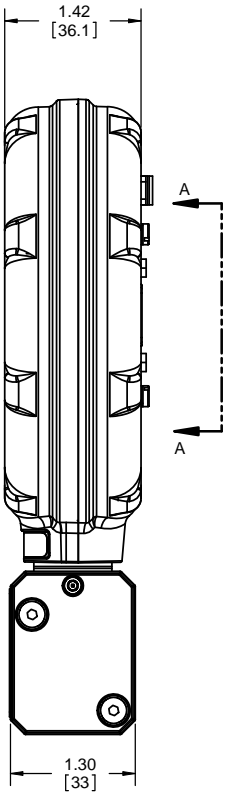
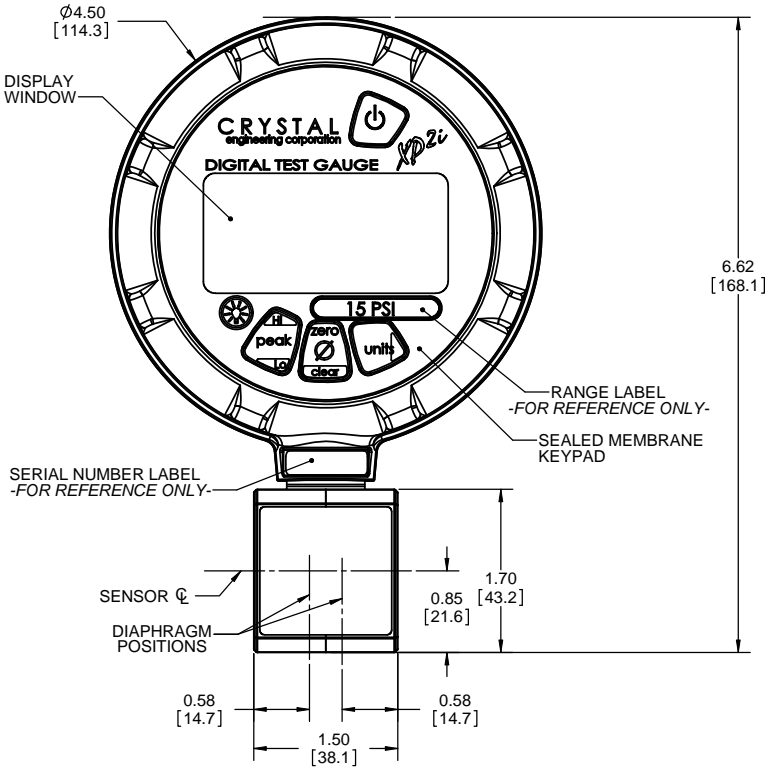

**SPECIFICATIONS**

**PRESSURE RANGE:** SEE PRESSURES AND RESOLUTIONS CHART  
**PRESSURE ACCURACY:** 20 - 100% OF FULL SCALE ±(0.1% OF READING)  
 0 - 20% OF FULL SCALE ±(0.02% OF FULL SCALE)  
 STATIC LINE PRESSURE EFFECT: 0.0003 PSI PER PSI APPLIED  
**POWER:** THREE AA (1.5V) AA; RAYOVAC MAXIMUM PLUS, ENERGIZER® E91, ENERGIZER® EN91, OR DURACELL MN1500. USE OF ANY OTHER BATTERY VOIDS INTRINSIC SAFETY RATINGS  
**PRESSURE CONNECTION:** TWO 1/8"-27 FEMALE NPT.  
**ENCLOSURE:** NICKEL-PLATED ALUMINUM ALLOY CASE, AUTOFLEX-EBG10 MEMBRANE SWITCH PANEL.  
**WEIGHT:** 915 g (2.0 lbs), INCLUDING BATTERIES  
**PRESSURE PORT MEDIA COMPATIBILITY:** LIQUID AND GASES COMPATIBLE WITH 300 SERIES STAINLESS STEEL AND BUNA-N (O-RING).  
**OPERATING AND COMPENSATED TEMPERATURE RANGE:** -10°C TO +50°C (14°F TO 122°F).  
**STORAGE TEMPERATURE RANGE:** -40°C TO +75°C (-40°F TO 167°F).  
**CERTIFICATIONS:**  
**INTRINSICALLY SAFE:**  
 CSA: CLASS I, DIVISION 1, GROUPS A, B, C, AND D - T4 (CANADA AND U.S.)  
 ATEX: Ex II 1 G Ex ia IIC T4 KEMA 04ATEX 1053 X  
 IECEx SCHEME: IECEx CSA 05.0001X  
 Ex ia IIC T4  
**OTHER:**  
 C-TICK: COMPLIES WITH AUSTRALIAN C-TICK  
 DNV: COMPLIES WITH DNV'S RULES FOR CLASSIFICATION OF SHIPS, HSLC AND OFFSHORE STANDARDS

DIMENSIONS ARE IN INCHES [MILLIMETERS]  
 SPECIFICATIONS SUBJECT TO CHANGE WITHOUT NOTICE.  
 PROTECTIVE BOOT OPTION SHOWN ON SHEET 2  
 MOUNTING FLANGE AND REAR PORT OPTIONS SHOWN ON SHEET 2

**PRESSURES AND RESOLUTIONS**

AVAILABLE PRESSURES				AVAILABLE UNITS AND DISPLAY RESOLUTIONS								
PSI	bar	kPa (1)	OVERPRESSURE (+/- PORTS)	PSI	kg/cm2	"Hg	"H2O	mmHg	mmH2O	kPa	bar	mbar
15	1	100	6.5x / 3.0x	0.001	0.0001	0.001	0.01	0.01	1	0.01	0.0001	0.1
100	7	700	2.0x / 2.0x	0.01	0.0001	0.01	0.1	0.1	1	0.01	0.0001	0.1

(1) kPa MODELS DISPLAY PRESSURE IN kPa, MPa, bar, mbar if applicable.

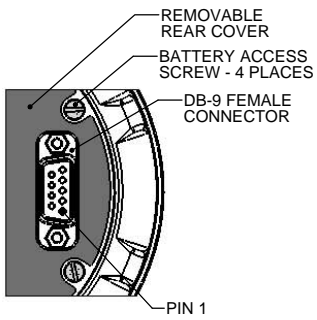
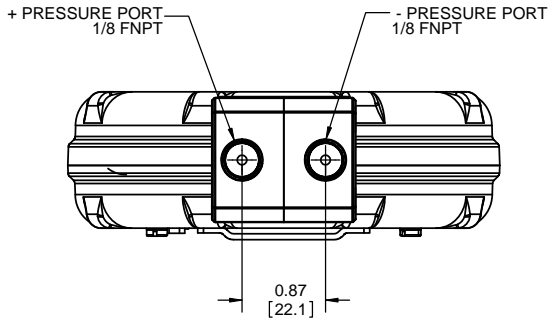

SECTION A-A  
RS232 CONNECTOR

**CONNECTOR PINOUT**

PIN	FUNCTION
1	NC
2	TX
3	RX
4	DTR
5	COM
6	NC
7	RTS
8	NC
9	NC

**PROPRIETARY NOTICE**  
 THIS DOCUMENT AND ANY DATA DISCLOSED HEREIN IS THE SOLE PROPERTY OF CRYSTAL ENGINEERING CORPORATION AND MAY NOT BE REPRODUCED, USED OR DISCLOSED IN PART OR IN WHOLE, TO ANYONE WITHOUT THE WRITTEN CONSENT OF CRYSTAL ENGINEERING CORPORATION.

UNLESS OTHERWISE SPECIFIED DIMENSIONS ARE IN INCHES  
 TOLERANCES ARE:  
 FRACTIONS DECIMALS ANGLES  
 .XXX ± .005  
 .XXXX ± .001

**CRYSTAL** (805) 595-5477  
 engineering corporation www.crystalengineering.net

**XP2I SERIES PRESSURE GAUGE**

APPROVALS	DATE	SCALE: 1:1	SIZE <b>C</b>	DRAWING NO. <b>3673</b>	REV <b>B</b>
DRAWN M.J.Cain	10/11/06				
CHECKED D. Porter	10/20/06	DO NOT SCALE DRAWING			
MFG. ENGR. M.J.Cain	10/20/06	SHEET 1 OF 2			
D.A. M. Merrill	10/23/06				

Ø4.88  
[124]

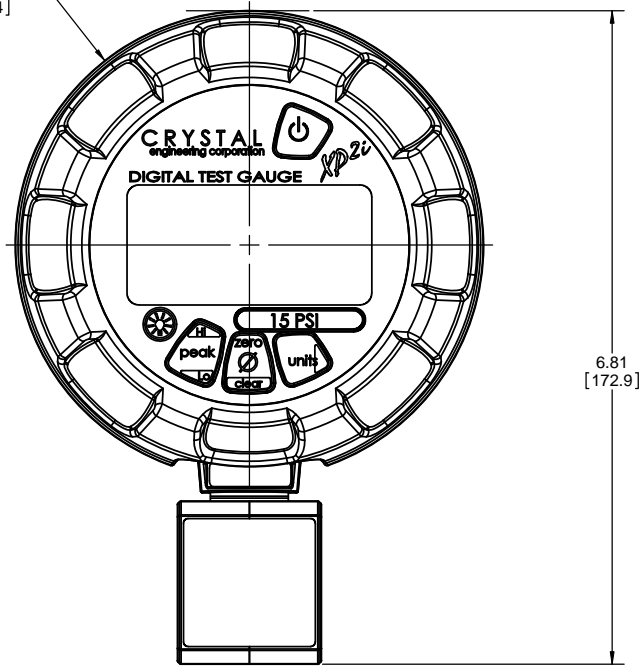

UNIT SHOWN WITH OPTIONAL PROTECTIVE BOOT

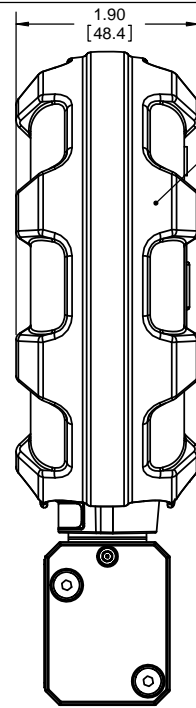

**PROTECTIVE BOOT**  
 COLOR: BLUE  
 MATERIAL: POLYPROPYLENE BLEND  
 HARDNESS: 55 SHORE A

REVISIONS			
REV.	DESCRIPTION	DATE	APPROVED
-	See Sheet1	-	-

NOTES:  
 REFER TO SHEET 1

SEE "XP2i FLANGE MOUNTING KIT ASSEMBLY INSTRUCTIONS"  
 (CRYSTAL ENGINEERING P/N 3962) FOR FLANGE MOUNT PANEL  
 CUT-OUT DIMENSIONS, TEMPLATE AND ASSOCIATED INFORMATION.

Ø4.94  
[125.5]  
 PANEL OPENING  
 PER ASME B40.1

NICKEL PLATED  
 ALUMINUM FLANGE

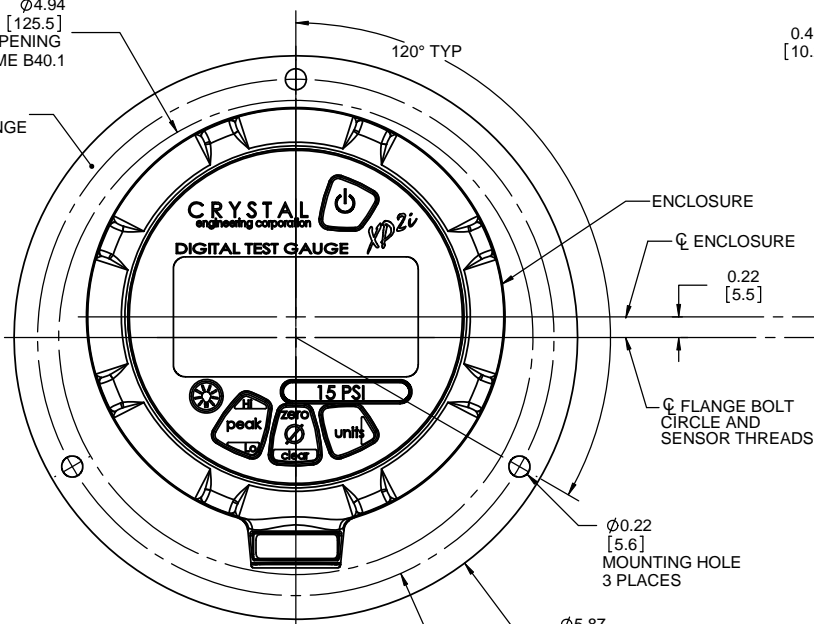

UNIT SHOWN WITH OPTIONAL MOUNTING  
 FLANGE AND REAR PORT (-F4)

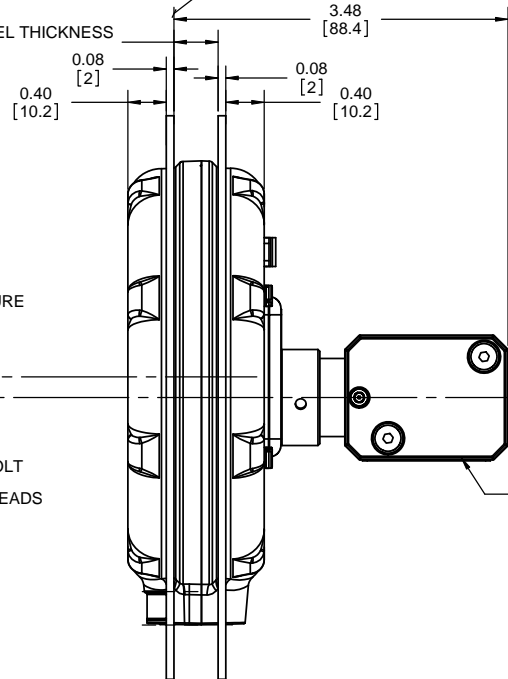

**REAR PORT CONFIGURATION**  
 NOTE: REAR PORT IS AVAILABLE AS AN  
 OPTION WITHOUT FLANGE (-RP)

**PROPRIETARY NOTICE**  
 THIS DOCUMENT AND ANY DATA DISCLOSED HEREIN  
 IS THE SOLE PROPERTY OF CRYSTAL ENGINEERING  
 CORPORATION AND MAY NOT BE REPRODUCED, USED  
 OR DISCLOSED IN PART OR IN WHOLE, TO ANYONE  
 WITHOUT THE WRITTEN CONSENT OF CRYSTAL  
 ENGINEERING CORPORATION.

UNLESS OTHERWISE SPECIFIED  
 DIMENSIONS ARE IN INCHES  
 TOLERANCES ARE:  
 FRACTIONS DECIMALS ANGLES  
 .XXX ± .005  
 .XXXX ± .001

APPROVALS	DATE
DRAWN M.J.Cain	10/11/06
CHECKED D. Porter	10/20/06
MFG. ENGR. M.J.Cain	10/20/06
D.A. M. Merrill	10/23/06

**CRYSTAL** (805) 595-5477  
 engineering corporation www.crystallengineering.net

**XP2i SERIES PRESSURE GAUGE**

SCALE: 1:1	SIZE <b>C</b>	DRAWING NO. <b>3673</b>	REV <b>B</b>
DO NOT SCALE DRAWING		SHEET 2 OF 2	