

XP2i Flange Mounting Kit Assembly Instructions

The following instructions are provided for proper assembly and installation of the XP2i Flange Mounting kit. A cutout template and illustrated parts list are included on the last two pages.

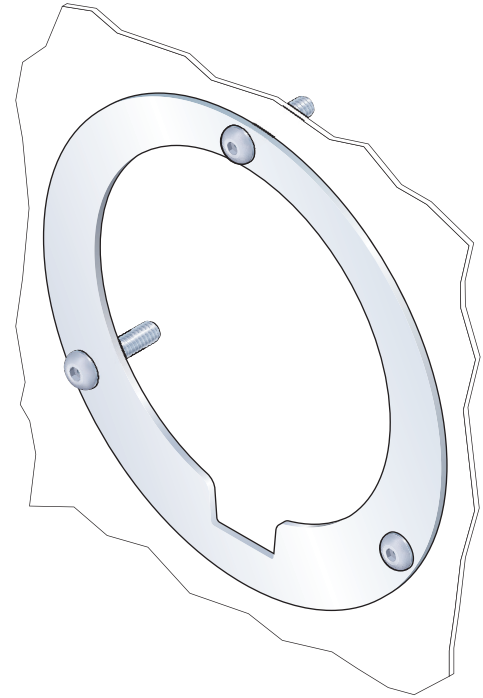

- 1 Install the Front Flange using three (3) 10-32 x 7/8" Socket Pan Head Screws and three (3) 10-32 Nuts.
 - 2 Tighten using a 3/8" wrench and the provided Hex Key.
- * **Note:** If necessary, the 10-32 Nuts can be installed from the front, working through the cut-out hole.

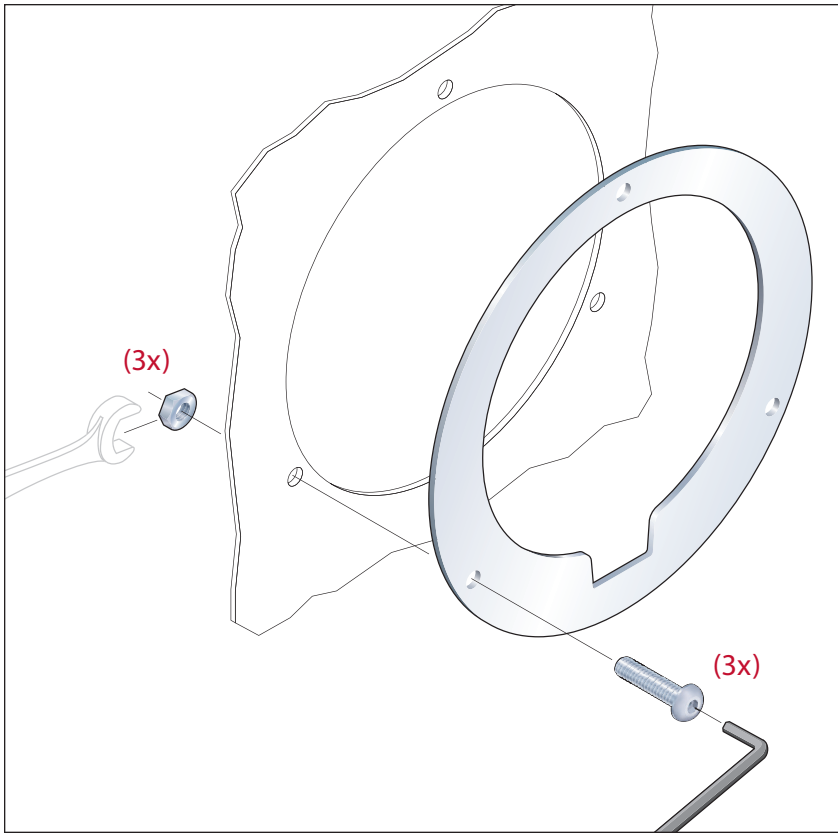
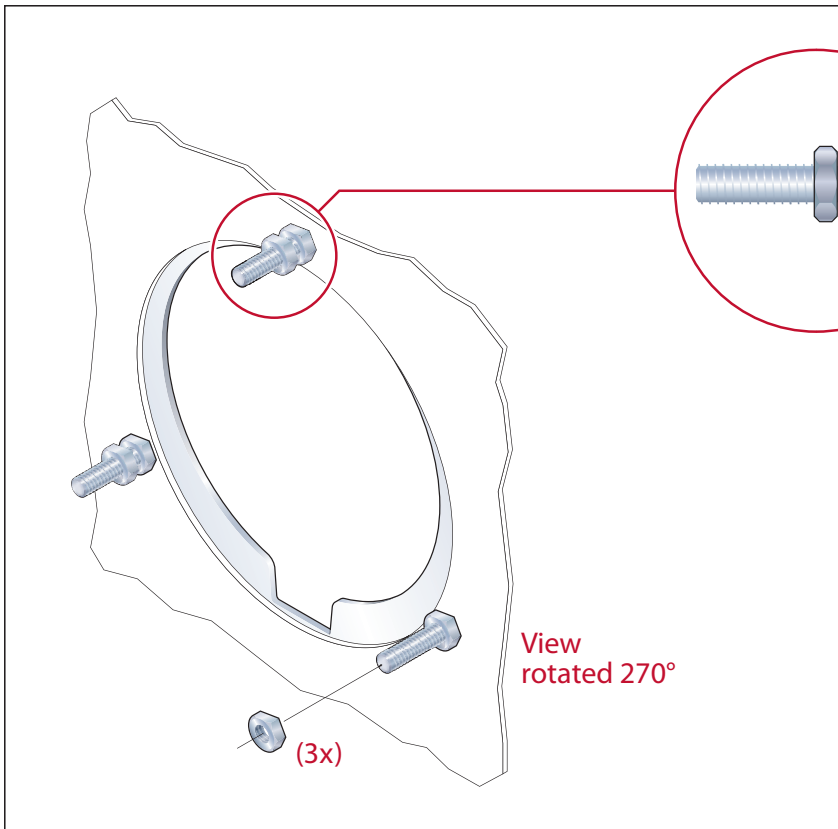

Detail, showing the two (2) 10-32 Nuts mounted on the 10-32 x 7/8" Socket Pan Head Screw.

- 3 Install one (1) additional 10-32 Nut onto each screw. Hand-tighten only.

XP2i Flange Mounting Kit Assembly Instructions

CONTINUED

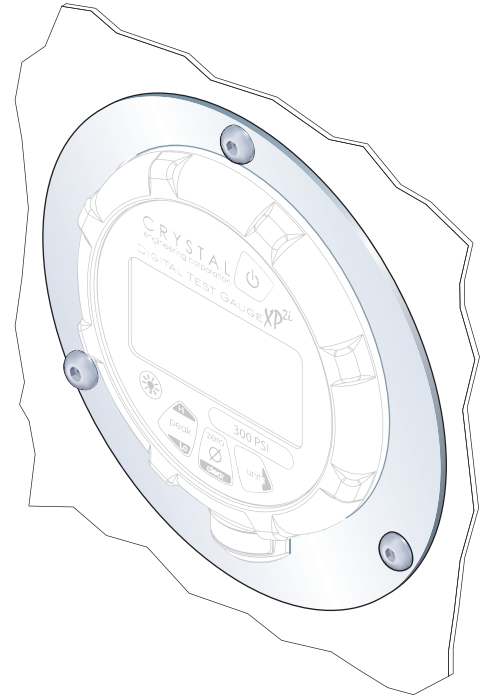
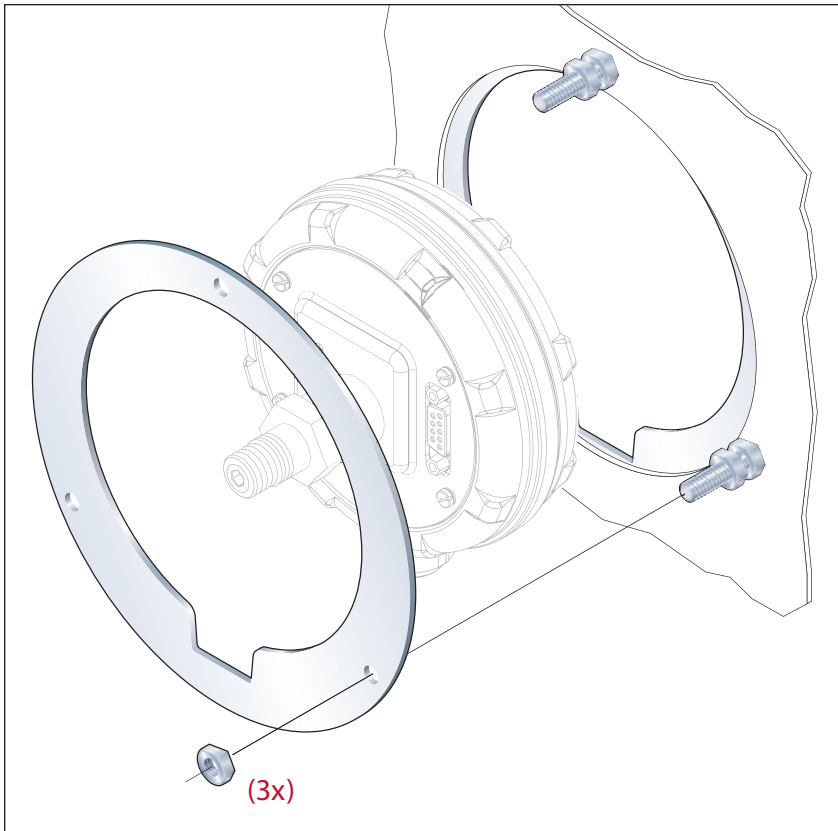

- 4 From the back side, install the Rear Port XP2i.
- 5 Install the Rear Flange over the XP2i using three (3) 10-32 Nuts. Tighten using a 3/8" wrench until the Rear Flange securely clamps the XP2i.

* **Note:** Do not overtighten.

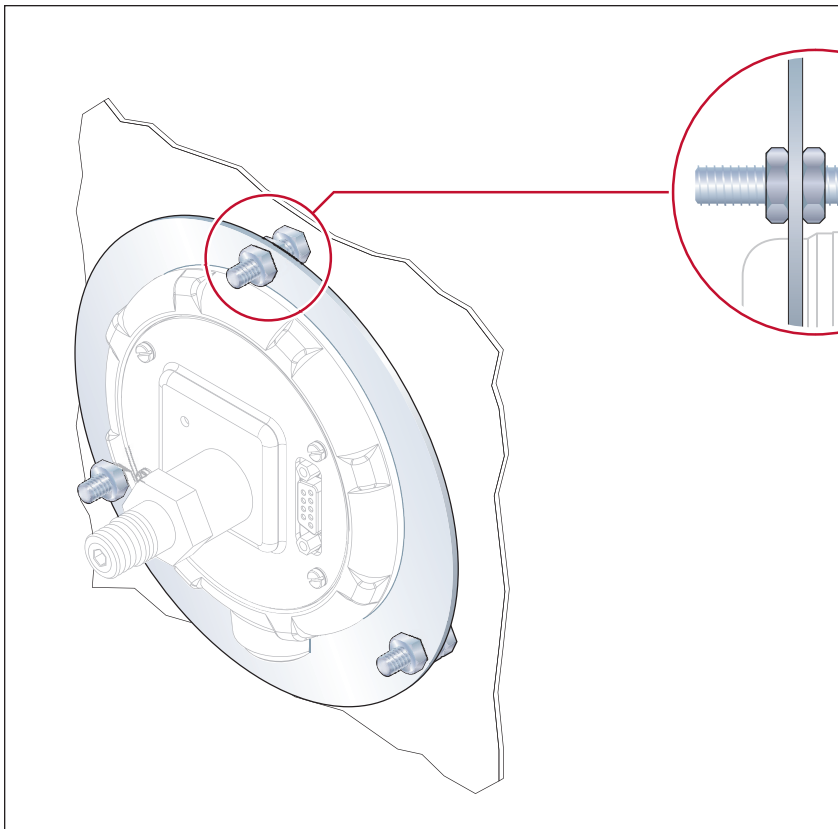

- 6 Back out each of the three (3) hand-tight nuts installed in step 3, until they fit snugly against the Rear flange.
- 7 Using a 3/8" wrench, tighten each of the three (3) nuts against the Rear Flange.

* **Note:** Due to the use of double nuts (aka *jam nuts*) the final assembly will be vibration resistant.

XP2i Flange Mounting Kit Cut-out Template

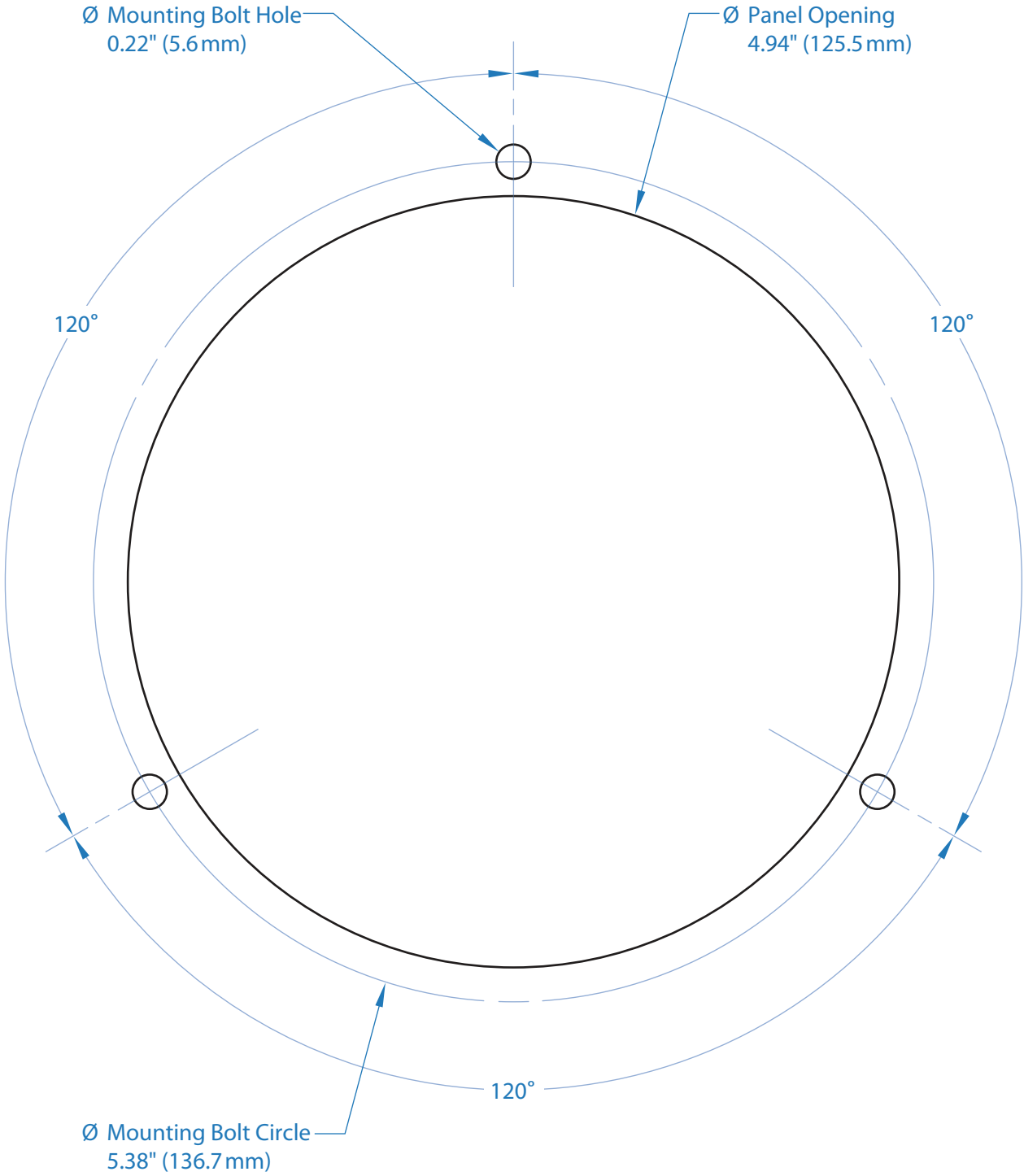

XP2i Flange Mounting Kit Parts List

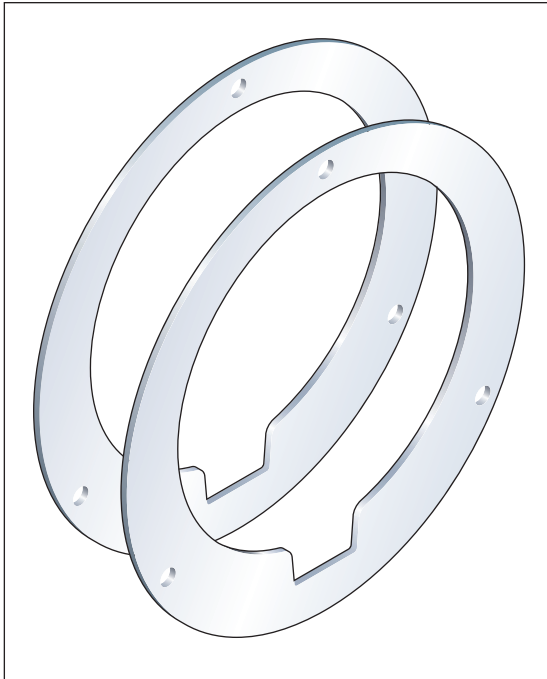

QTY 2 Flanges

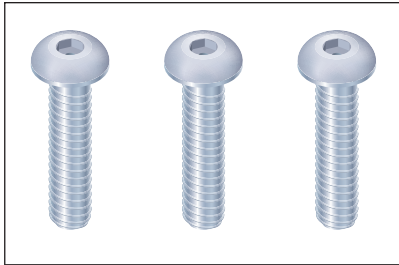

QTY 3 10-32 x 7/8" Socket Pan Head Screws



QTY 10 10-32 Nuts

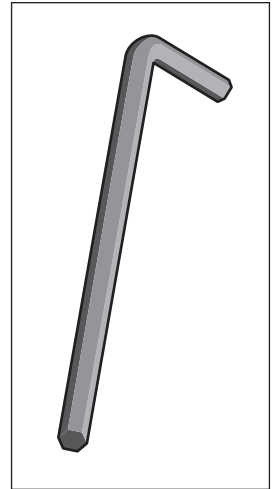

QTY 1 Hex Key

CRYSTAL
engineering corporation

Copyright © 2009 Crystal Engineering Corporation • 708 Fiero Lane, Suite 9, San Luis Obispo, California 93401-8701

No part of this document may be reproduced or modified in any form or by any means, electronic or mechanical, without express written permission from Crystal Engineering Corporation.

Visit us on the web at

www.crystalengineering.net

