

GaugeCalXP™

Handle retaining screw retrofit instructions

1. Using a 5mm Allen key, remove existing Handle Assembly cap screw and plastic or metal washer.
2. From the kit, install 2 metal washers (PN 4336A), and 2 rubber washers (PN 4337A) onto the shoulder bolt (PN 4335A). The rubber washers will be in-between the metal washers.

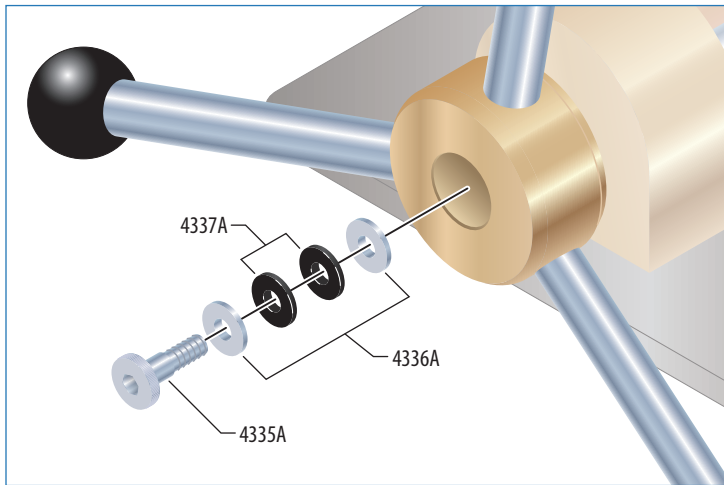

3. With the Leadscrew turned a few revolutions clockwise, so threads are visible on the other side of the bearing block, install the shoulder bolt assembly into the Handle Assembly using a 4mm Allen wrench. Tighten robustly.
4. Test free travel of piston/handle assembly. If it seems to turn less easily than it did before the retrofit, back it all the way out (counter-clockwise) and turn an extra $\frac{1}{4}$ revolution. This will seat the shoulder bolt assembly and free up the travel.



© 2010 Crystal Engineering Corporation

708 Fiero Lane, Suite 9, San Luis Obispo, California 93401-8701